

A

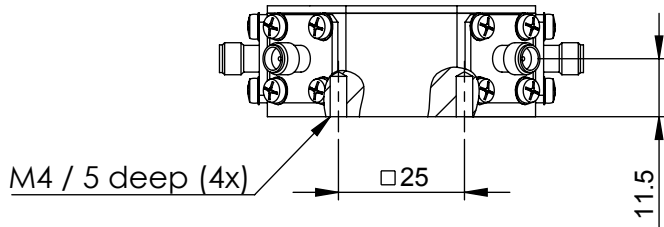

B

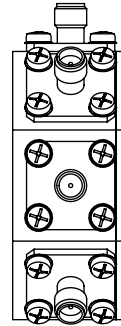
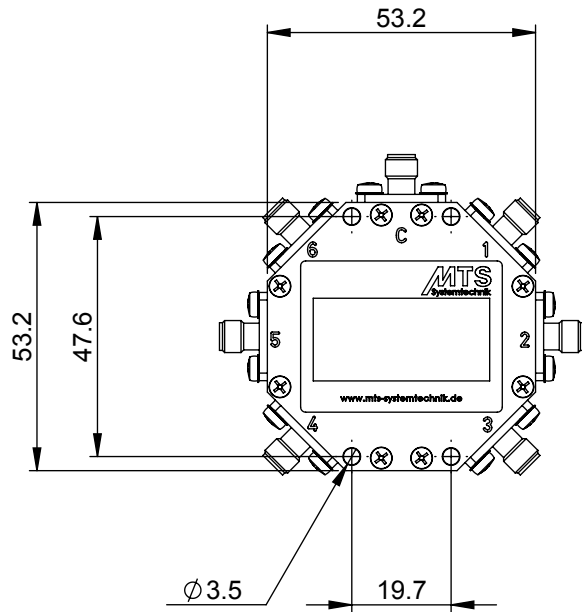

C

D

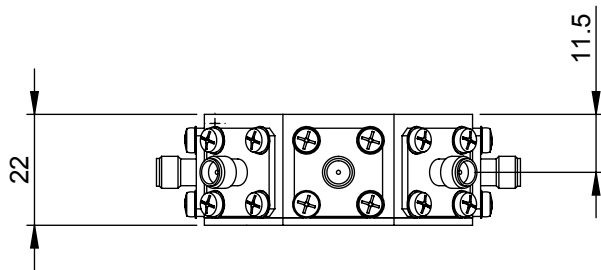

E

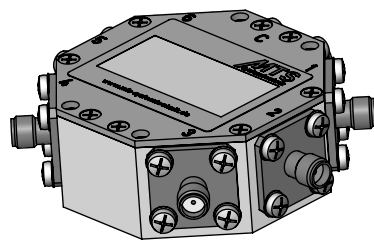

F

Oberfläche SurTec 650 (chromitAL)				Rohm./Halbzeug	
Masstab 1:1,5		Det. Masstab		Toleranz ± 0.2	
				Werkstoff Alu	
				Datum	
				Name	
				Bearb. 16.6.15 G.Jaumann	
				Gepr.	
				Freiga. 16.06.15 Jaumann	
0		16.6.15 G.Jaumann		Leistungsteiler	
Zust. Änderung		Datum Name		RS6-544P-3G	
				25079-Z01	
				Blatt 1	
				von 1	
Schutzvermerk ISO16016 beachten					